

Slimline Assembly Instructions For Multiple Tanks

1) Position both tanks side by side

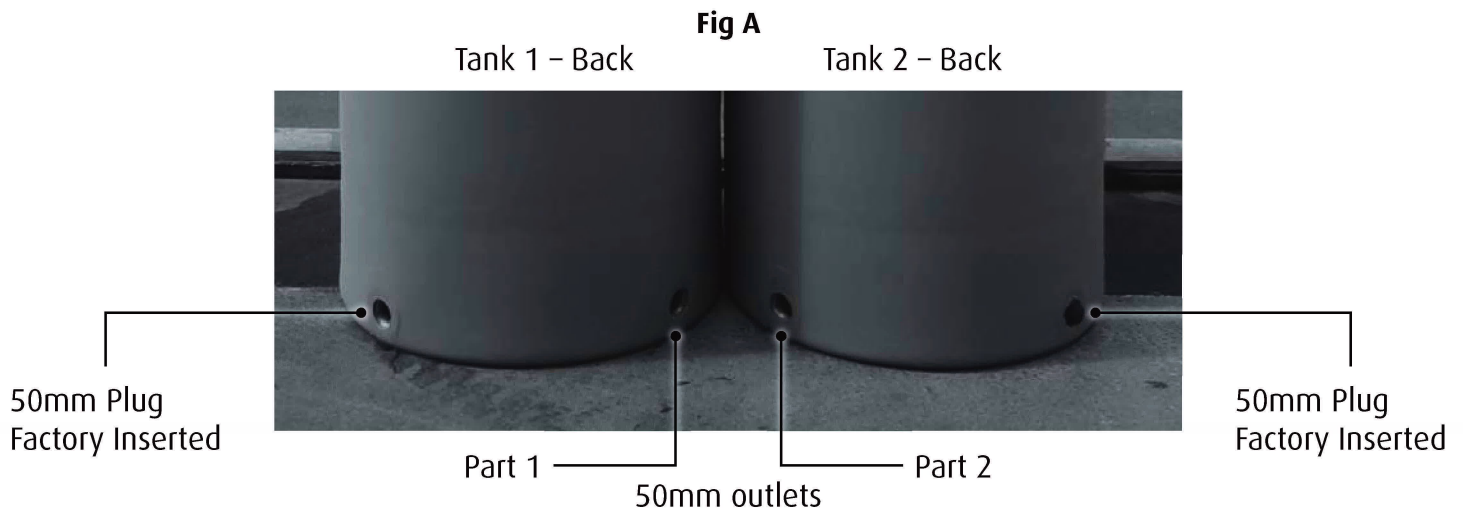

2) Apply thread tape (10-12 turns) around the thread of Fig B and Fig C

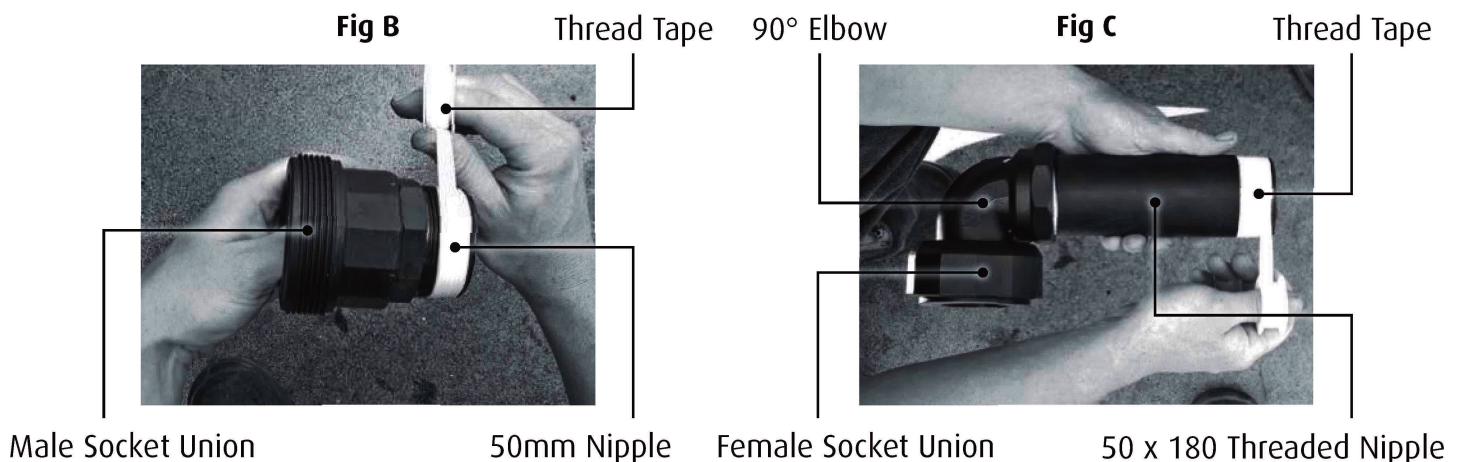

3) Install Fig B into part 1 of Fig A

NOTE: Do not over tighten

4) Install Fig C into part 2 of Fig A

NOTE: Do not over tighten

Ensure the mac union runs parallel to the ground



5) Push tanks together so that Fig B and Fig C come together

6) Screw the mac union together and tighten with Multi-Grips

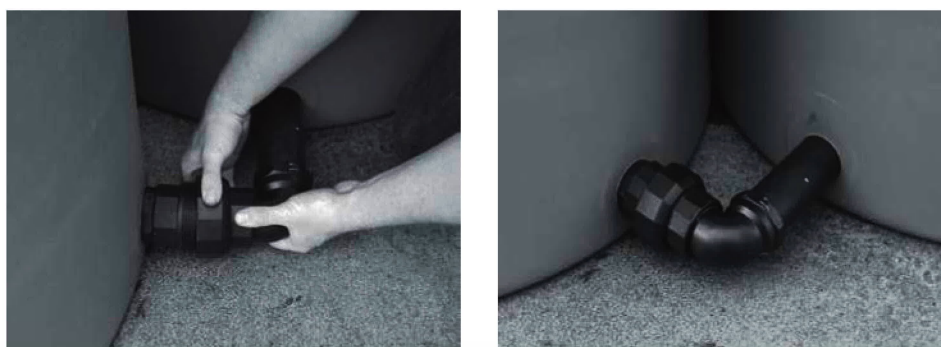

7) Carefully slide the tanks into position against the house



It is the users responsibility to ensure a solid foundation (concrete or pavers).

The inlet and overflow positions are indicative only and can be changed to suit differing requirements

Failure to follow these installation instructions will void the tank warranty.

FREEPHONE: 0800 5000 26
WWW.DEVAN.CO.NZ

DEVAN TANKS