

Puremix Z2

Compact High Flow Undersink Filter System

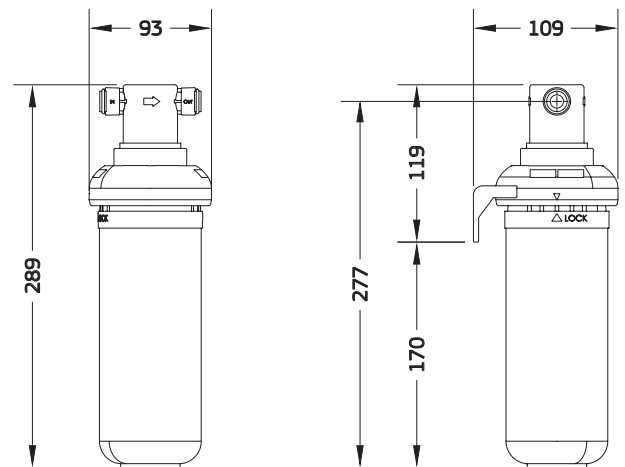

MAINS WATER



Note: All dimensions are in mm.

Parts Included

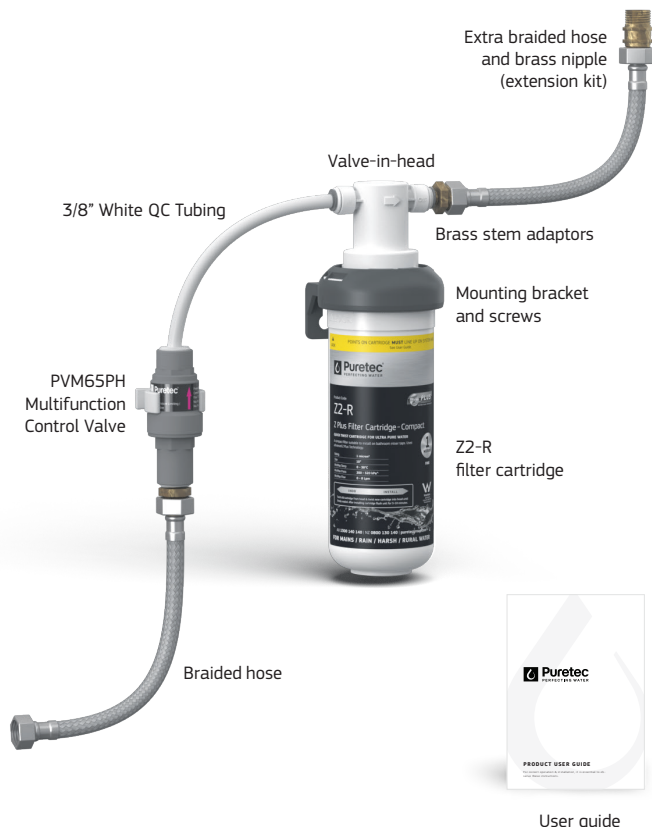

Specifications

Ordering Code	Temp °C	Pressure** (kPa)	Flow (Lpm)	Micron Rating*	Connection	Cartridge Size	Capacity*** (L)
Puremix-Z2	0-38	200-520	8	1	1/2" BSP [15mm]	10"	38,000

Notes: Specifically designed for mains, rain, harsh, and rural water supply. Connects to any mixer tap or dedicated filter tap. Unit can be installed vertically or horizontally. Protect from freezing.

Replacement Cartridge: Z2-R.

APPROXIMATE SPACE REQUIRED

Vertical Mount : 290 mm (h) x 90 mm (w)	Horizontal Mount : 90 mm (h) x 290 mm (w)
---	---

Z PLUS FILTRATION TECHNOLOGY

STAGE 1	<ul style="list-style-type: none"> Removes particles Clarifies the water Removes sediment, rust, sand, silt and algae filtering down to 1 micron*
STAGE 2	<ul style="list-style-type: none"> Reduces chlorine and other chemicals Eliminates bad taste and odours
STAGE 3	<ul style="list-style-type: none"> Antibacterial technology inhibits bacterial growth within the system Incorporates anti-scaling protection

Warranty:

Use only genuine Puretec replacement cartridge. 10 year warranty^ is 1 year parts and labour, plus 9 years parts only. Excludes cartridges.



Warning: Please visit www.puretec.com.au/instructions to observe essential manufacturer's instructions before use. Note: No claims can be made based on the specifications and images in this document. The design, technology, colours, features and prices are subject to change. This document and all its contents are copyright protected. All rights are reserved, particularly alteration, translation and reproduction using electronic systems. This spec sheet has been designed to help make product selection easy. However due to the complex nature of water chemistry, we strongly encourage confirming any product selection with one of our team. We may need to perform a water analysis test to confirm contaminants in water. **Caution:** Do not use with microbiologically unsafe water or water of unknown quality without adequate disinfection before or after the system. **Warranty:** Warranties in this document cover parts for the period stated and include cover for parts and labour for the first year where applicable, subject to approval. Excludes consumables. Our Water Filtration Specialists can provide you with advice to suit your needs. *Where line pressure exceeds 520kPa, an approved pressure limiting device must be installed to comply with Australian & New Zealand Plumbing Standards. (Ref. AS 35001:2021, Clause 3.3.4). Maximum flow depends on cartridges, vessel, pressure, impurities etc. *Micron rating is nominal. ***Capacity is based on inlet chlorine @2ppm ±10%. The term 'removal', 'eliminate' and 'protection' indicates significant reduction, not necessarily 100% removal.