

Masport[®]
HEATING



AKAROA II

ULTRA-LOW EMISSION (ULEB) WOOD FIRE RANGE

The Masport Akaroa II wood fire combines conventional design with soothing warmth. Built with improved design, aesthetic appeal and for all regions in New Zealand, the upgrades were inspired by customer demand for a cleaner environment. The Akaroa is ideal for medium-sized homes offering powerful, clean-burning performance to keep you warm and cosy throughout winter.

masportheating.co.nz

AKAROA II ULTRA-LOW EMISSION (ULEB) WOOD FIRE RANGE

The Akaroa II wood fire's sleek tall frame allows for easier loading of wood, the small footprint and contemporary design makes this model suitable for a wide range of architectural styles and compliments rooms with high ceilings. The Akaroa II comes in two base options - a built-in, concealed ash pan or a wood stacker for convenient storage solutions.

- ▶ Ultra-clean burning that is better for air quality
- ▶ Large portrait window with an expansive flame view
- ▶ Small footprint ideal for small spaces
- ▶ Ceramic Fire Bricks for greater heat retention and durability
- ▶ Stainless Steel Boxed Baffle for superior performance and longevity
- ▶ Lower long-term running costs due to quality components
- ▶ Start-Up Latch mechanism for ease of operation and safety
- ▶ Does not require electricity
- ▶ A future proof solution for all NZ regions - clean air zones and rural installations



Finish	Metallic Black VHT
Space Heat Output**	Suitable for medium to large homes (3-4 bedrooms)
Dimensions w x d x h	482 x 537 x 1039 mm

BASE OPTION	ASH PAN	WOOD STACKER
Fire Only	999933	999934
Flue Only	GDFLU018M	GDFLU018M
Fire & Flue Pack	AKAROAMK2PACK	AKAROAMK2WSPACK



Ultra M3 technology incorporates a fusion of 3 key features to elevate the performance, clean burning, safety and lower maintenance costs.



Future proof your purchase to protect the New Zealand natural environment.

Clearance Specifications

Minimum distance to heat sensitive materials (mm) when a Masport double skin flue shield is fitted as per Masport specifications.

Model	Space Heat Output	Type of Flue Shield	Type of Floor Protector	A	B	C	D	E	F	G	H	I	J	K	L	M	N	R	W
⊕ Akaroa II Ash / Woodstacker	SML-MED	MDSS	AFP	94	344	300	144	287	271	584	507	470	770	920	1390	1180	673	717	482

Flue Shields

MDSS Masport Double Skin Flue Shield 600mm long

Floor Protectors

AFP Ash Floor Protector

Masport Steel Floor Protectors

Parallel - 998901 & 998908
Corner - 998904

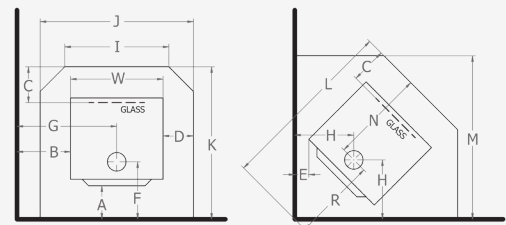

* Refer to the specification sheet for full details of the clearance distances and heat capacity and output.

**Space Heat Output is only a guide based on homes with average insulation, window area, and 2.4m ceiling heights. Differences in these factors, as well as others like, geographical location, layout of the house, living room size, type of windows all play a part in choosing the right model for your heating needs. Consult your dealer or installation contractor for more information.



Glen Dimplex New Zealand Ltd PO Box 58473, Botany, Auckland

Glen Dimplex New Zealand Ltd's policy is one of continuous development. We reserve the right to change size and specifications without notice. For the latest product information and warranty details please refer to www.masportheating.co.nz. Please refer to the installation and operation instructions before having your Masport Wood Fire installed. A full set of these instructions is supplied with each fire.